

공사계획평면도(18)

(북정역 교차로-4)

S = 1 : 100

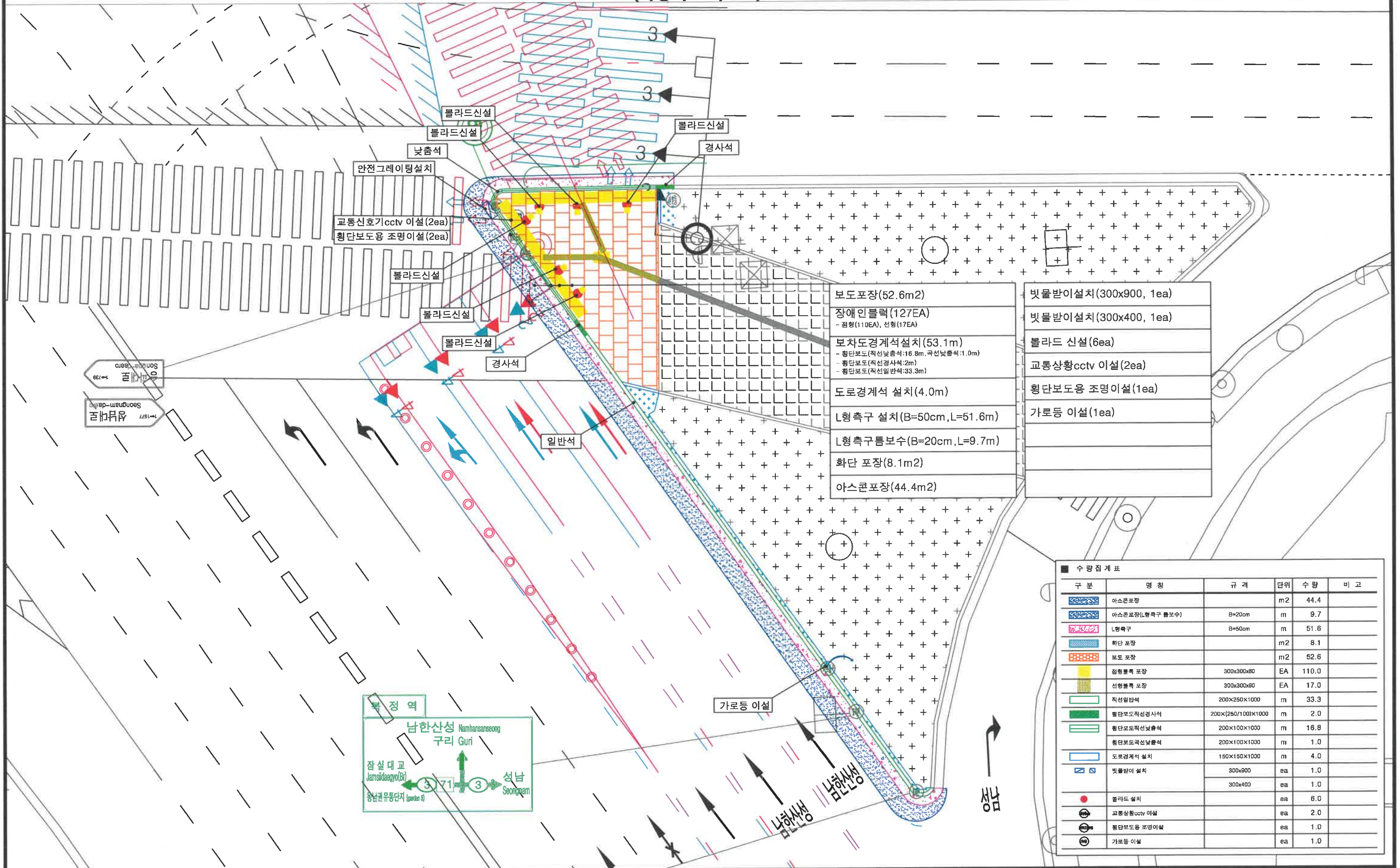

- 보도포장(52.6m²)
- 장애인블럭(127EA)
- 고행(110EA), 신행(17EA)
- 보차도경계석설치(53.1m)
- 횡단보도(직선낮출석:16.8m, 곡선낮출석:1.0m)
- 횡단보도(직선경사석:2m)
- 횡단보도(직선일반석:33.3m)
- 도로경계석 설치(4.0m)
- L형측구 설치(B=50cm, L=51.6m)
- L형측구틀보수(B=20cm, L=9.7m)
- 화단 포장(8.1m²)
- 아스콘포장(44.4m²)

- 빗물받이설치(300x900, 1ea)
- 빗물받이설치(300x400, 1ea)
- 블라드 신설(6ea)
- 교통상황cctv 이설(2ea)
- 횡단보도용 조명이설(1ea)
- 가로등 이설(1ea)

■ 수량집계표

구분	명칭	규격	단위	수량	비고
	아스콘포장		m ²	44.4	
	아스콘포장(L형측구 틀보수)	B=20cm	m	9.7	
	L형측구	B=50cm	m	51.6	
	화단 포장		m ²	8.1	
	보도 포장		m ²	52.6	
	침형블럭 포장	300x300x80	EA	110.0	
	신행블럭 포장	300x300x80	EA	17.0	
	직선일반석	200x250x1000	m	33.3	
	횡단보도직선경사석	200x(250/100)x1000	m	2.0	
	횡단보도곡선낮출석	200x100x1000	m	16.8	
	횡단보도곡선낮출석	200x100x1000	m	1.0	
	도로경계석 설치	150x150x1000	m	4.0	
	빗물받이 설치	300x900	ea	1.0	
		300x400	ea	1.0	
	블라드 신설		ea	6.0	
	교통상황cctv 이설		ea	2.0	
	횡단보도용 조명이설		ea	1.0	
	가로등 이설		ea	1.0	



공사계획평면도(16)

(북정역 교차로-2)

S = 1 : 100

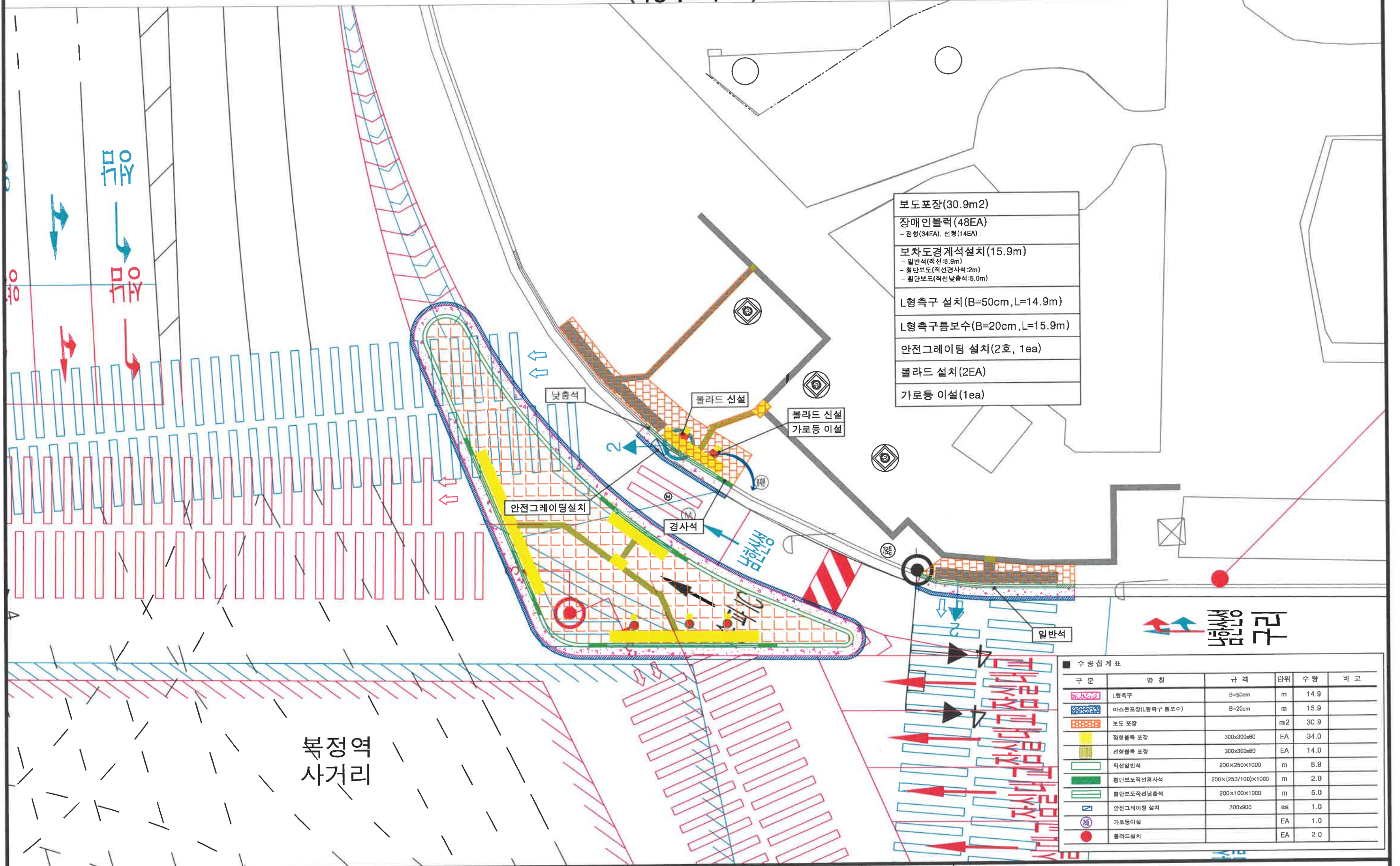

- 보도포장(30.9m²)
- 장애인블럭 (48EA)
- 점형(34EA), 선형(14EA)
- 보차도경계석설치(15.9m)
- 일반석(직선:8.9m)
- 횡단보도(직선경사석:2m)
- 횡단보도(직선낮춤석:5.0m)
- L형측구 설치(B=50cm, L=14.9m)
- L형측구틀보수(B=20cm, L=15.9m)
- 안전그레이팅 설치(2호, 1ea)
- 블라드 시설(2EA)
- 가로등 이설(1ea)

■ 수량집계표

구분	명칭	규격	단위	수량	비고
[Symbol]	L형측구	B=50cm	m	14.9	
[Symbol]	아스콘포장(L형측구 틀보수)	B=20cm	m	15.9	
[Symbol]	보도 포장		m ²	30.9	
[Symbol]	점형블럭 포장	300x300x60	EA	34.0	
[Symbol]	선형블럭 포장	300x300x60	EA	14.0	
[Symbol]	직선일반석	200x250x1000	m	8.9	
[Symbol]	횡단보도직선경사석	200x(250/100)x1000	m	2.0	
[Symbol]	횡단보도직선낮춤석	200x100x1000	m	5.0	
[Symbol]	안전그레이팅 설치	300x900	ea	1.0	
[Symbol]	가로등이설		EA	1.0	
[Symbol]	블라드설치		EA	2.0	

북정역
사거리

횡단보도구간 포장상세도

평면도

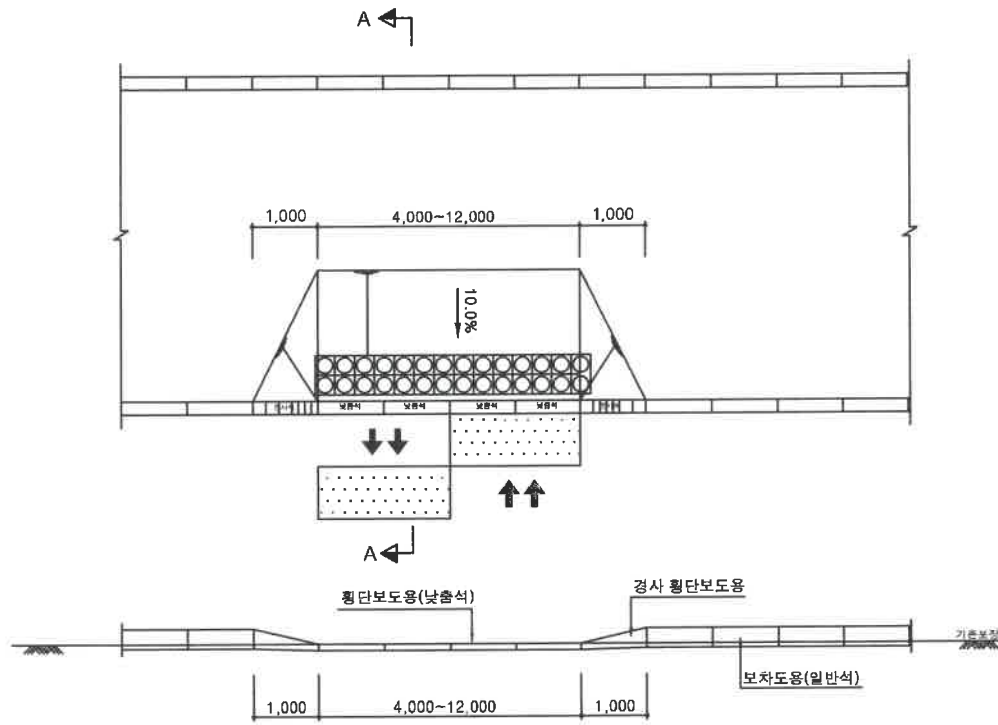

단면 A-A

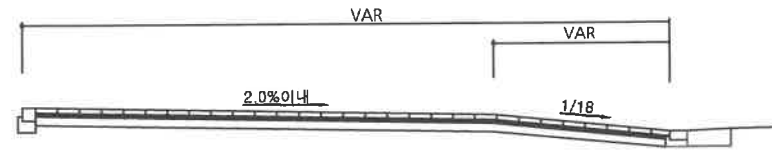

점자(유도)블록 상세도

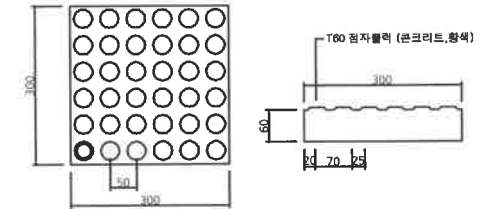
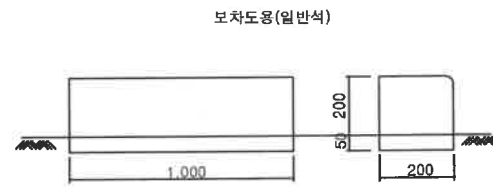

경사 횡단보도용

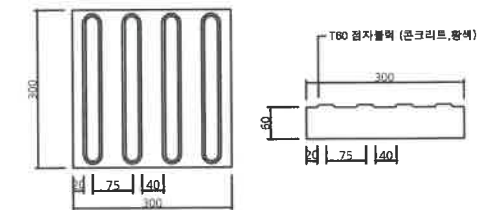
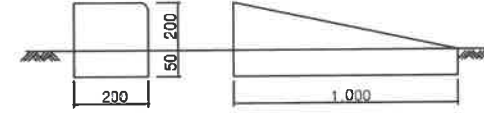

횡단보도용(낮출석)

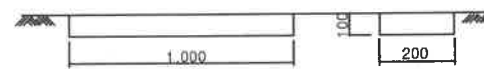

■ 보도폭 6m이상: 횡단보도 전체 폭 턱낮춤

■ 보도폭 3m이상~6m미만: 횡단보도 전체 폭 턱낮춤

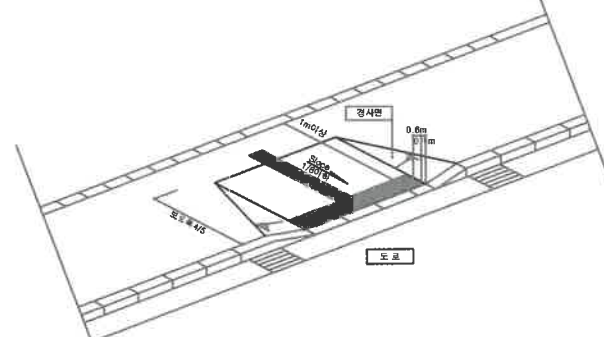
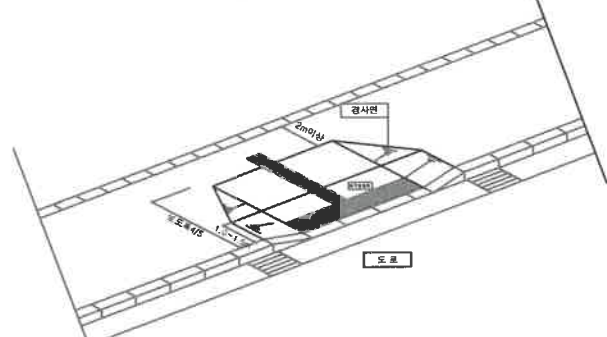

■ 보도폭 2m이상~3m미만: 횡단보도 전체 폭 턱낮춤

■ 보도폭 2m미만: 횡단보도 전체 폭 턱낮춤

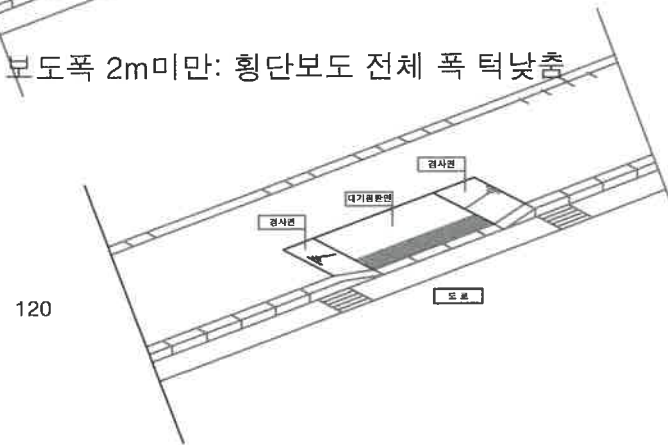
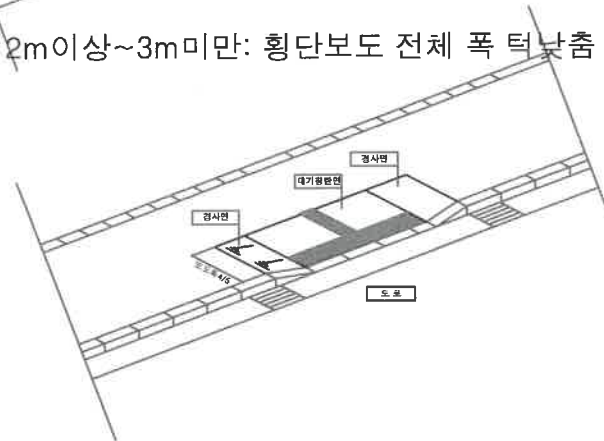

■ 횡단보도 주변 블라드 및 음향신호기 설치 예시도

■ 낮춤턱구간도 일반경계석 사용(파손방지)

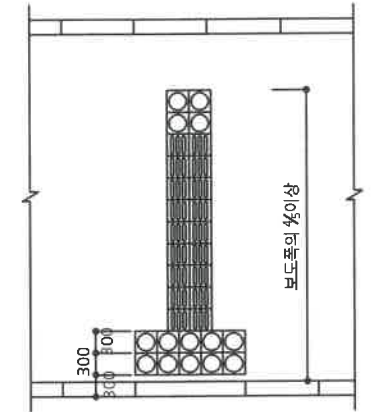
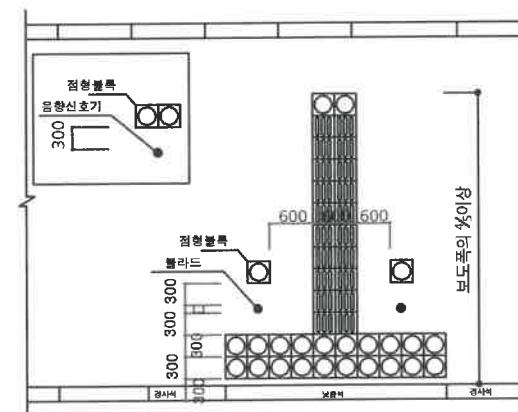

경계석 및 포장단면상세도

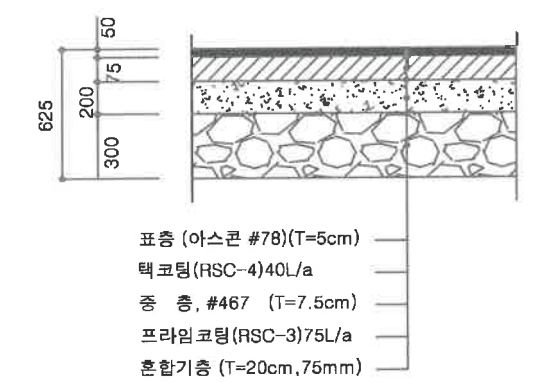
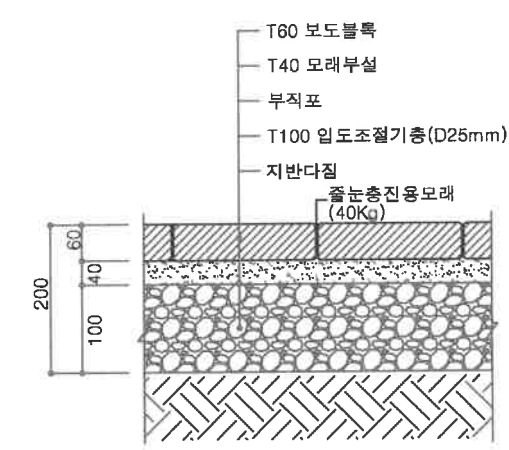
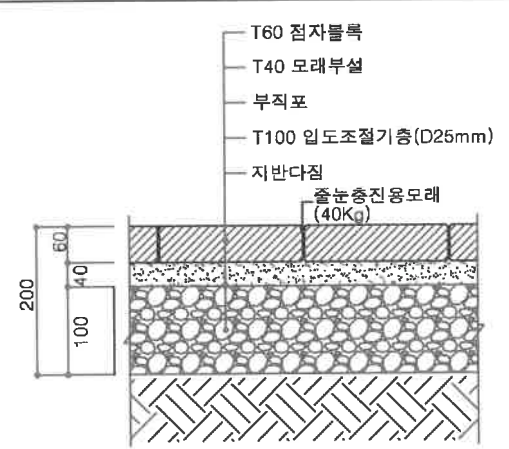
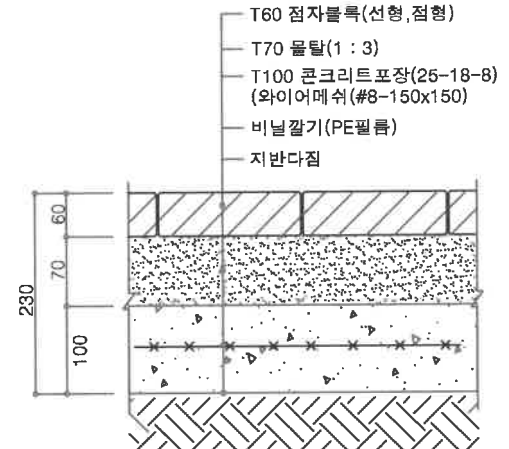
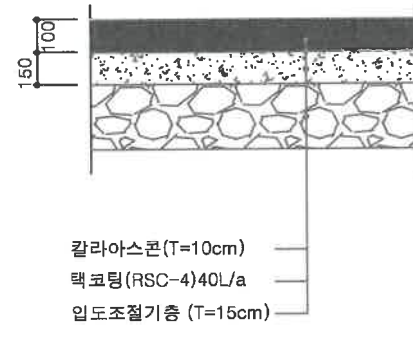
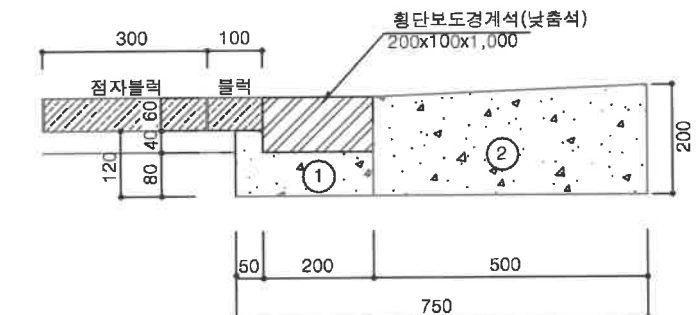
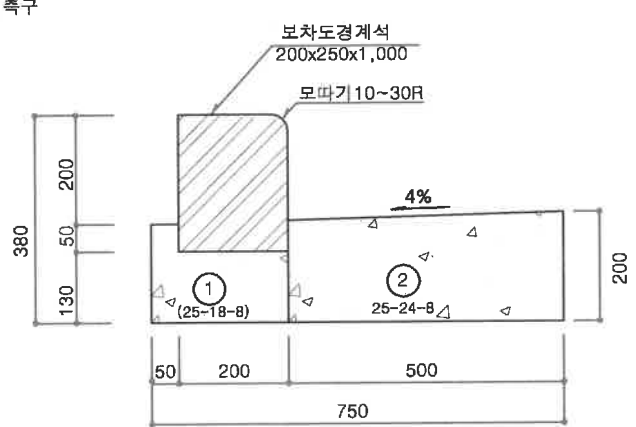
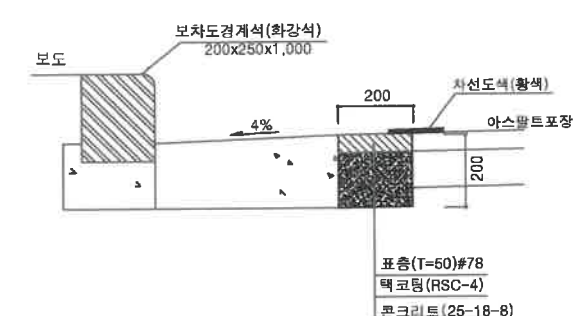
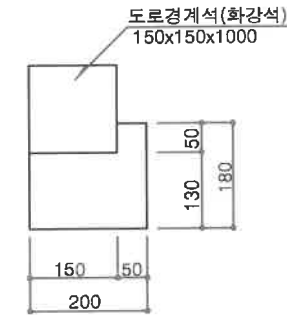
 <p>표층 (아스콘 #78) (T=5cm) 텍코팅 (RSC-4) 40L/a 중층, #467 (T=7.5cm) 프라이코팅 (RSC-3) 75L/a 혼합기층 (T=20cm, 75mm)</p>	 <p>T60 보도블록 T40 모래부설 부직포 T100 입도조절기층 (D25mm) 지반다짐 중부충진용모래 (40Kg)</p>	 <p>T60 점자블록 T40 모래부설 부직포 T100 입도조절기층 (D25mm) 지반다짐 중부충진용모래 (40Kg)</p>
01 포장표준단면도	02 콘크리트블록포장 (모래기초)	03 점자블록포장 (모래기초)
 <p>T60 점자블록(선형, 점형) T70 몰탈(1:3) T100 콘크리트포장(25-18-8) (와이어메쉬(#8-150x150)) 비닐깔기(PE필름) 지반다짐</p>	 <p>칼라아스콘 (T=10cm) 텍코팅 (RSC-4) 40L/a 입도조절기층 (T=15cm)</p>	 <p>① 보차도경계석 ② L형측구</p> <p>횡단보도경계석(낮춤석) 200x100x100</p>
04 점자블록포장 (몰탈기초)	05 자전거도로포장단면도	06 횡단보도경계석(낮춤석) 상세도
 <p>① 보차도경계석 ② L형측구</p> <p>보차도경계석 200x250x100 모따기 10~30R</p>	 <p>보차도경계석(화강석) 200x250x100</p> <p>차선도색(황색) 아스팔트포장</p> <p>표층 (T=50) #78 텍코팅 (RSC-4) 콘크리트 (25-18-8)</p>	 <p>도로경계석(화강석) 150x150x100</p>
07 보차도경계석	08 L형측구 틈보수	09 도로경계석